

wave

Be Alert!
Safety First!

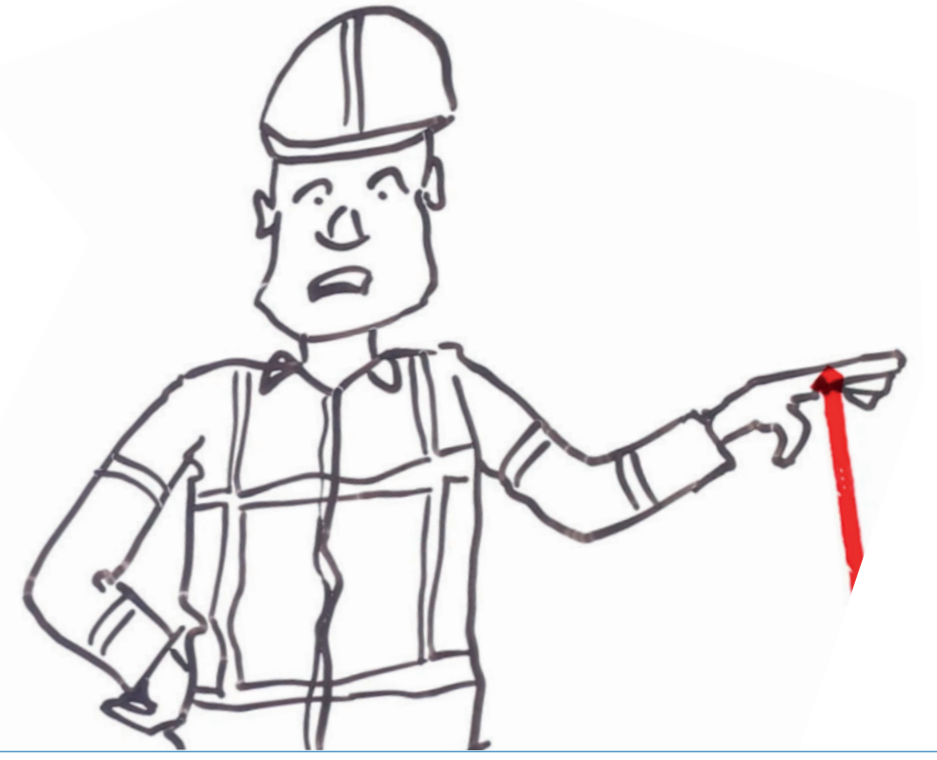

CUTTING INCIDENTS

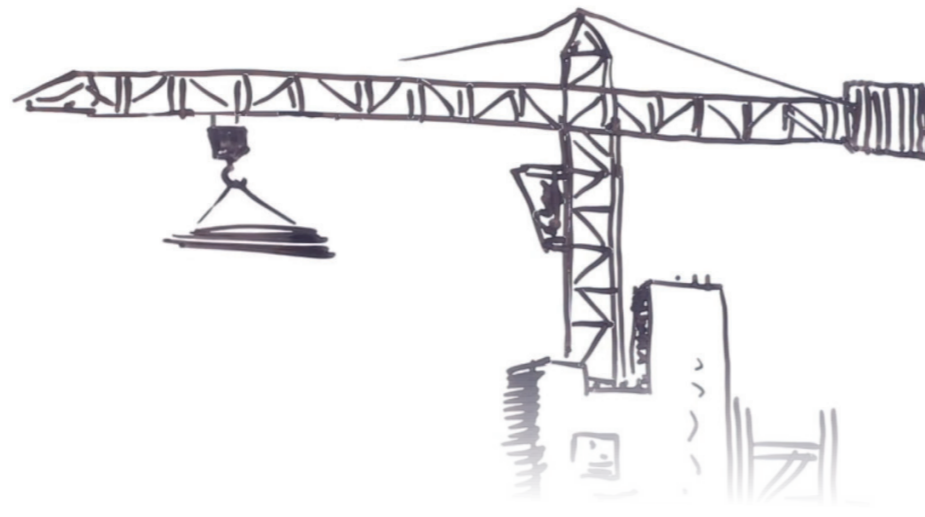

281

INCIDENTS



68%
HAND



7%
LEG



11%
ARM



6%
HEAD

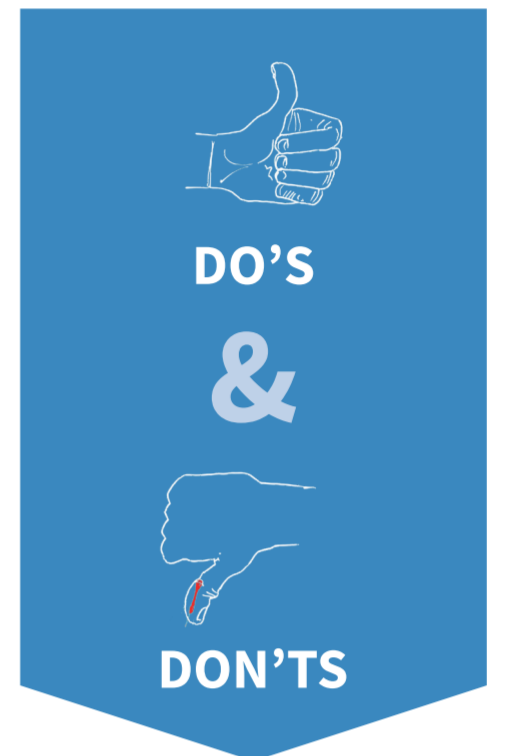

CUTTING KNIVES

CUTTING AND/OR SHARP OBJECT

USE GLOVES WITH A HIGH CUTTING CLASS

IS THE CUTTING KNIFE NECESSARY?

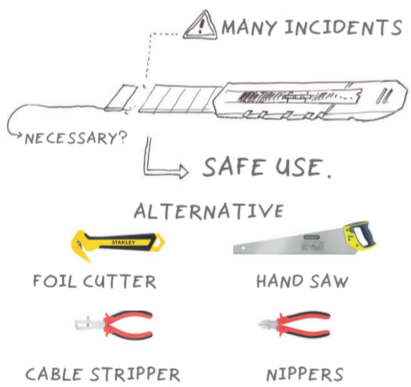

Does the work really have to be done with a knife, or can it also be done with another type of tool.

USE A SAFETY KNIFE!

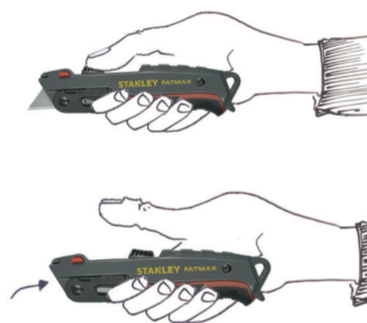

With this type of knife, the blade automatically retracts.

SUPPLY CONSTRUCTION MATERIALS SAFELY PACKED

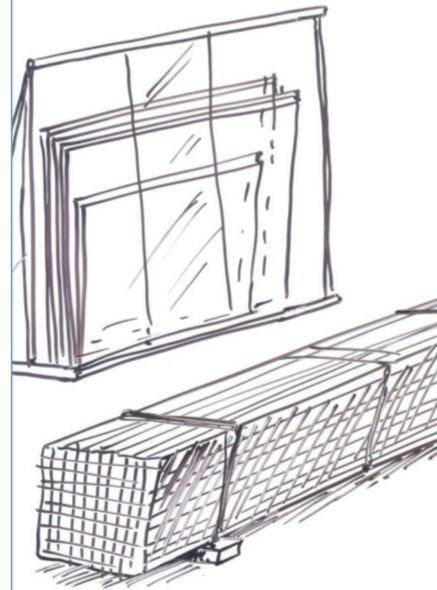

Have cutting construction materials supplied properly and securely packed.

KEEP WALKING ROUTES FREE OF SHARP OBJECTS



Do not store cutting or sharp construction materials along the walking route.

Hands and skin are vulnerable to cuts. Cuts can easily become infected. Deep wounds can damage the delicate structure of nerves and tendons irreparably.

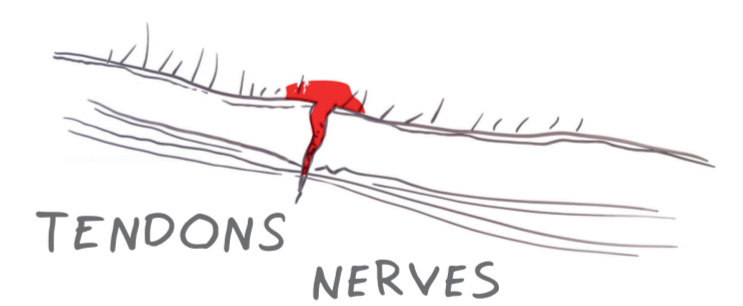

VolkerWessels therefore recommends gloves of cutting class **4 or 5**

SHARP KNIFE



Always use a sharp knife.

STABLE GROUND

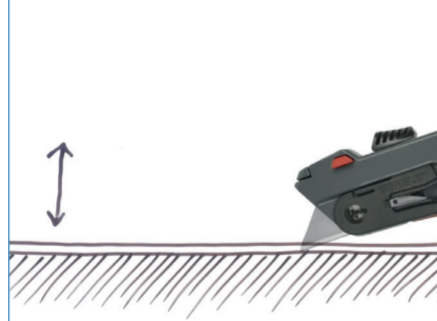

Make sure the workpiece to be cut is stable, even under pressure.

APPROPRIATE PPE



BODY COVERING CLOTHES: LONG SLEEVES, NO SHORTS

Always wear appropriate PPE when piling up and working with cutting construction materials

MECHANICAL PILING

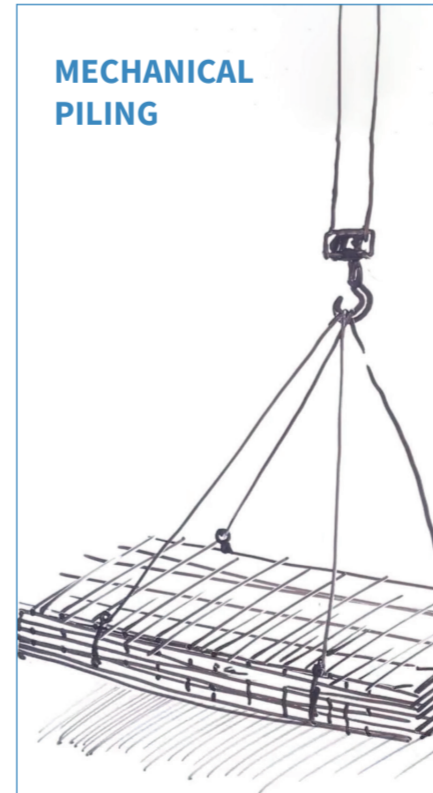

Whenever possible, pile cutting construction materials mechanically.

CORRECT CUTTING DIRECTION



Preferably make a cutting movement away from the body.



CUTTING CLASS
4 OR 5
RECOMMENDED



QUESTIONS?



KAM COORDINATOR
OF YOUR COMPANY



WWW.VOLKERWESSELS.COM

WATCH THE
INSTRUCTION VIDEO